

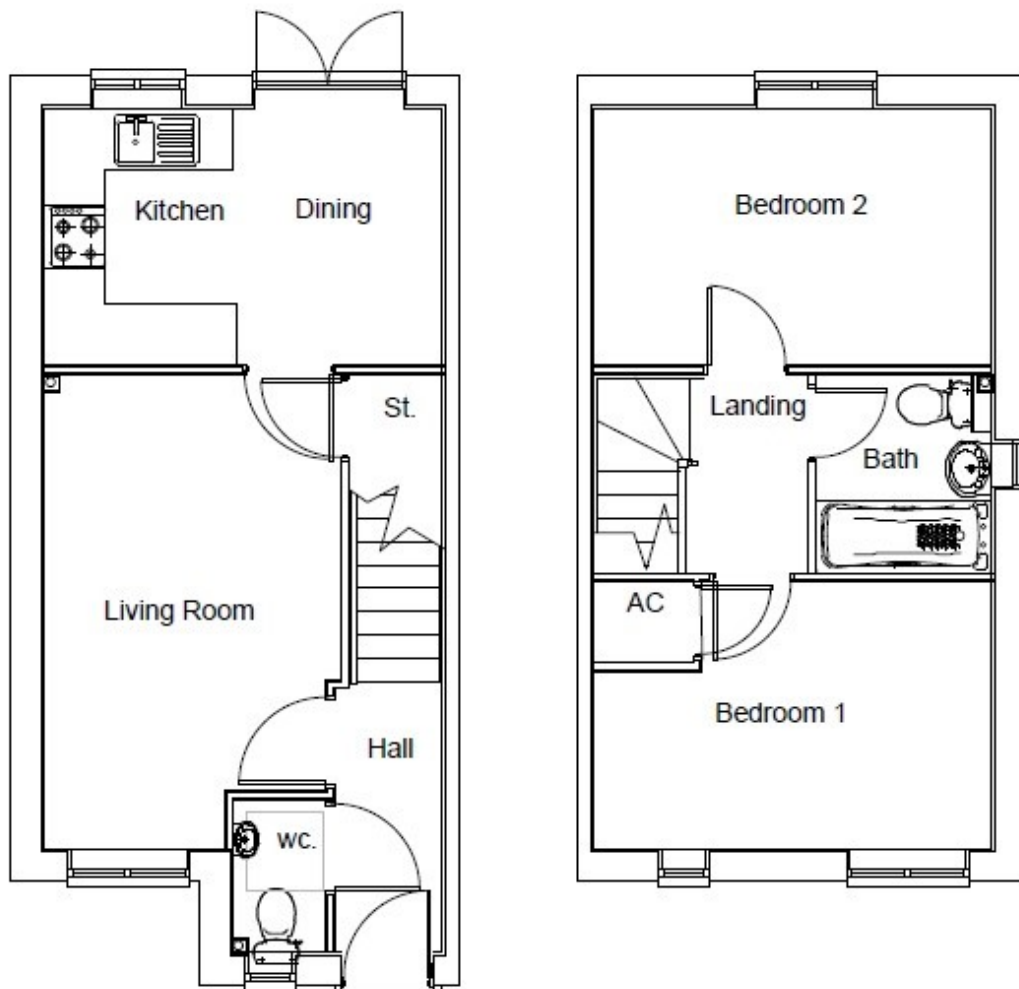

2 Bedroom houses in Shaftesbury.

Rent for £520 per month.

Buy after 5 to 20 years with a 10% gifted deposit.+



Dimensions may not be exact. Do not use to measure for carpets or furniture.

Plots 7, 8, 15, 16, 23, 24

Image of typical Rentplus homes.

Chilmark Glade

Chilmark Glade, Off Mampitts Lane, Shaftesbury,
Dorset, SP7 8GT

Chilmark Glade is a wide development of new build housing on the east side of Shaftesbury. Tamar and Rentplus have two 1 bedroom flats, four 2 bedroom flats and six 2 bedroom houses available on affordable rent to buy.

Chilmark Glade is location just off the A30 Salisbury Road and has excellent links to the town centre. Shaftesbury offers a range of education, shopping and leisure facilities.

Salisbury is only 20 miles away and offers even wider facilities. A short drive away is Gillingham train station, which is on the mainline between the South West and London for further afield travel.

To apply for these Rentplus properties you must have successfully registered with Dorset Home Finder. No boats, caravans or large commercial vehicles allowed on the estate. Appropriate working from home businesses are permitted.+



Five year period example.

Two bed house.

Property value now: £165,000*

Market rent: £650 pcm*

Rentplus rent: £520 pcm*

Expected value in year 5: £145,200**

Rent savings for deposit: £7,800*

10% gifted deposit: £14,520*

Total deposit: £22,320

Mortgage amount needed: £122,880*

Fifteen year period example.

Two bed house.

Property value now: £165,000*

Market rent: £650 pcm*

Rentplus rent: £520 pcm*

Expected value year 15: £145,200**

Rent savings for deposit: £23,400*

10% gifted deposit: £14,520*

Total deposit: £37,920

Mortgage amount needed: £107,280*

*Figures estimated guidance as of October 2017 **Estimated value in today's money with deduction of newbuild premium.

+ Full details available from housing officer.

All plans and drawings are subject to change.